

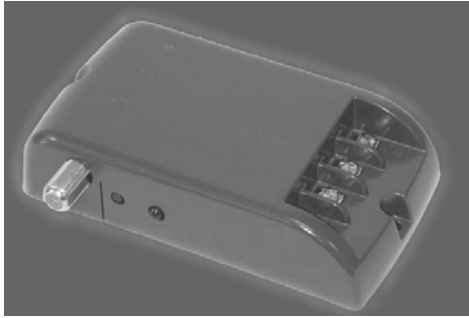

P.O. Box 67 Mt. Hope, OH 44660
(888) 827-3667

Radio Receiver

Models: 3990-372, 3994-433
Installation Instructions
and Owner's Manual



Radio Receiver Specifications

Operating Temperature Range:.....-22 F to 160 F
IP (Ingress Protection, International Protection):... IP20

NOTICE: Dry Locations Only

INPUT POWER

Non-polarized input connection.
10 to 28 VDC, 40 mA with relay off, 60 mA with relay active
10 to 28 VAC, 40 mA with relay off, 90 mA with relay active

NOTICE: Class 2 product, for voltages 32 VAC/DC or less

RELAY OUTPUT CONTACTS

Normally-open, dry contacts, non-polarized connection.
Switching current capability:1.0 mA to 0.5 A at 10 to 28 VAC and 2.0 mA to 1.0 A at 10 to 28 VDC

RF Center Frequency:.....Model 3990-372, 372.5 MHz.
Model 3994-433, 433.92 MHz.

Antenna length:.....Model 3990-372, 7.2 inch
Model 3994-433, 5.8 inch

Capable of learning 14 transmitters (any combination of portable transmitters, RF wall-stations or RF keypads).

IMPORTANT NOTICE!

Read the enclosed instructions carefully before installing this radio receiver. Pay close attention to all warnings and notes. This manual should be retained for future reference.

© Copyright 2007 Wayne-Dalton Corp. Part No.318705 Rev 3/ 7/19/2007

Package Contents:

1. Receiver
2. Antenna
3. Twin-lead wire, 6 feet
4. Manual

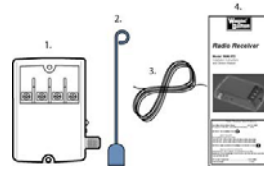

Optional Accessories:

1. Power Adapter
2. Antenna Extension Kit

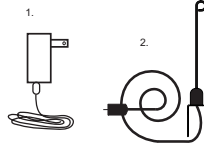

Definition of Symbol



Warning

Installation Safety Precautions

WARNING: INCORRECT INSTALLATION CAN LEAD TO SEVERE OR FATAL INJURY. FOLLOW THESE INSTRUCTIONS CAREFULLY.

READ and FOLLOW all installation instructions.

1. Before installing this receiver, read the door or gate operator's instruction manual fully, so you are aware of all of the unit's functions and features.
2. Wear protective gloves to install, repair, or adjust door, gate, or operator to avoid hand injuries.
3. Wear eye protection when using tools to install, repair, or adjust door, gate, or operator to prevent eye injuries.
4. Mount control buttons within sight of door or gate, at a minimum height of 5 ft, so small children cannot reach them. Keep control buttons away from all moving parts of a door and at least 6 ft away from all moving parts of a gate or its operator.
5. Before installing receiver, disconnect all power to door or gate operator to prevent unintended operation.
6. Do not connect this receiver to a power source until instructed to do so. Do not reconnect power to the door or gate operator until instructed to do so.
7. Only install receiver on a properly functioning door or gate operator.
8. Installation and wiring must comply with local building and electrical codes. This product is not intended and must not be installed in an explosive environment.
9. Pay close attention to all warnings, notices, and notes in these instructions.
10. To prevent electrical shock and/or fire hazards, do not connect this receiver to any voltages greater than 32 VAC or DC.

WARNING: After installing and testing this receiver, test all safety features of your door or gate's operator. Disconnect this receiver if any of your door or gate's safety system features fail to function properly. Then have your door or gate operator serviced immediately by a qualified person.

1

Preliminary Operator Tests:

1. Make sure door or gate operator has been properly installed in accordance with unit's installation instructions.

2. Test and confirm proper operation of the door or gate operator before proceeding with the installation of this receiver.

WARNING: Keep fingers and other body parts away from all moving parts of the door and gate operators system while the system is being operated.

WARNING: To prevent unintended operation, disconnect power to the door or gate operator after completing the above preliminary operator tests.

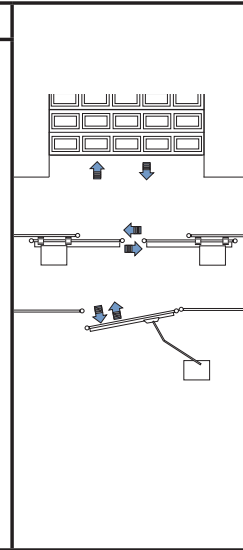

2

Mounting:

WARNING: Do not connect electrical power to this receiver until instructed to do so.

WARNING: Disconnect electric power to door or gate operator before making repairs or removing case covers.

1. Select a location four to six feet from other receivers. Receiver can be attached to metal, wood, or plastic surfaces.

2. Use screws or other fastening means to attach receiver.

3. If receiver is mounted inside a metal enclosure, use an antenna extension kit (optional) to extend the antenna outside of the enclosure.

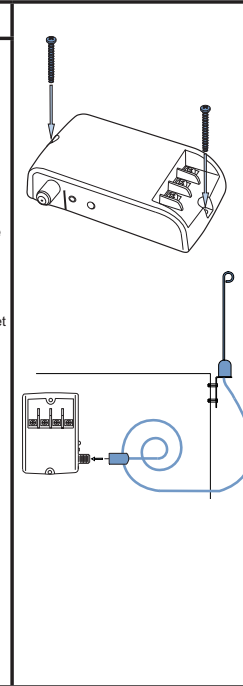

3

Wiring:

1. Disconnect power to the door or gate operator before proceeding.

WARNING: To prevent electrical shock, be sure electrical power is disconnected before proceeding with wiring.

2. Connect the enclosed twin-lead wires to the terminals labeled RLY. (use only 22 AWG or larger; CL2X or better)

3. Connect other end of twin-lead wires to door or gate opener's control input.

4. Connect power to the two terminals labeled PWR. Receiver requires 10V to 28V AC or DC.

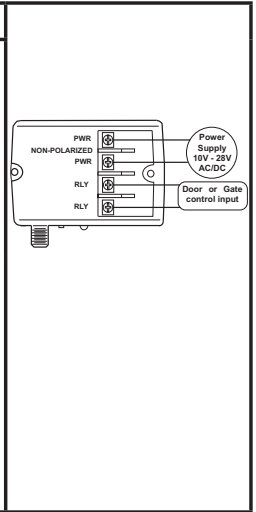

4

Connect Antenna:

Direct Connect Antenna: Attach antenna as shown. For best reception keep antenna wire straight and away from metal objects.

Antenna Extension Kit (Optional):

1. Connect extension wire to receiver.

2. Route wire outside metal enclosure. Route and secure wire away from moving parts.

3. Mount antenna holder outside enclosure.

4. Screw antenna to extension wire.

NOTICE: Do not route coax wire near any moving parts of the operator. If necessary, secure coax wire away from any moving parts.

5. Position antenna wire straight. For best reception, keep antenna away from metal.

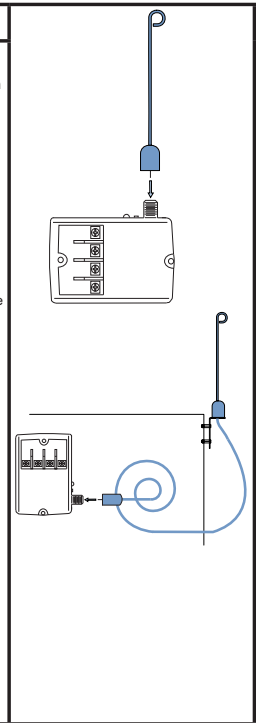

You can reach us Toll Free 1-888-827-3667 for Consumer Assistance or online at www.wayne-dalton.com

5

Connect Power Source:

If powered by **Power Supply:**
Plug power supply into source.

If powered by **Operator:**
Connect wires to the proper operator accessory supply source (10 V AC/DC to 28 V AC/DC source).

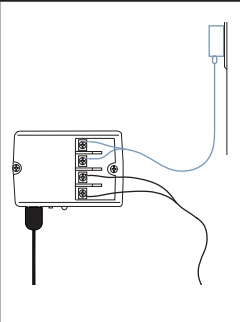

1. Re-connect power to the door or gate operator.
2. Using wall control, activate door or gate operator to confirm power connection.

6

Programming:

WARNING: Keep away from all high-voltage contacts while servicing receivers.

WARNING: During programming, door or gate operator will activate. Keep people and objects away from door or gate.

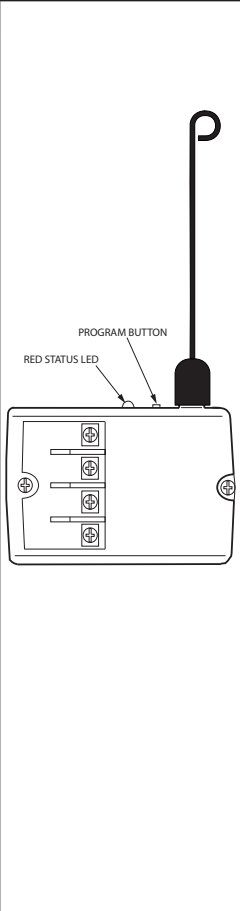

1. Test receiver by operating a compatible RF transmitter. The Receiver's STATUS LED will flash indicating reception.
2. Press and release the receiver's PROGRAM button once. The receiver's red STATUS LED will turn on and remain on for 25 seconds, indicating that the receiver is ready to learn a transmitter.
3. Press the button on the transmitter you wish to use to control the operator. The receiver's red STATUS LED will turn on and off three times indicating a successful learn.
4. Press the same button on the transmitter once more to confirm operation of the door or gate operator.
5. Test range of transmitter. Repositioning antenna may provide greater range.
6. Repeat Transmitter Programming steps for additional transmitters.

6 (continued)

To Erase All Learned Transmitters:

1. Press and hold down the PROGRAM button.
2. After 10 seconds, the red STATUS LED will blink 5 times indicating all transmitters are erased from the receiver's memory.
3. Release the PROGRAM button.
4. Re-learn transmitters as needed following the above Programming instructions.

7

Safe Operation Precautions

WARNING: To reduce the risk of severe or fatal injury.

1. Always keep a moving door or gate in sight and keep people and objects away until it is completely opened or closed.
2. No one should cross the path of a moving door or gate.
3. Never let children operate or play with the controls. Keep all controls away from children.
4. Never go under a stopped, partially open door. Never walk through a vehicular entry gate; always use the pedestrian entry.
5. Keep fingers and other body parts away from the all moving parts of the door, gate and operator system while the system is being operated.
6. Periodically test the safety systems of the door or gate. Disconnect and do not use this receiver if any of your door or gate's safety systems fail their tests. Then have door or gate operator serviced immediately.
7. **SAVE THESE INSTRUCTIONS.**

Operation:
Whenever this receiver senses a valid signal from a learned transmitter, the relay will activate for one second and, therefore, activate the operator.

1. Press and release selected button on Wayne Dalton transmitter.
2. Receiver LED will light and the unit will cycle.

Maintenance:
Disconnect electric power to door or gate operator before making repairs or removing case covers. While this receiver is maintenance-free, periodic cleaning of the receiver case is suggested. To clean the receiver case, disconnect power to receiver and operator and then use a soft cloth to remove any dirt and dust.

Service:
Unit contains no user serviceable parts. Contact your dealer or Wayne-Dalton customer support for additional information.

To Remove This Receiver From Service:

1. Disconnect power to operator (door operator, gate operator, etc.) and disconnect power to this receiver.
2. Disconnect all wiring connected to receiver. Disconnect antenna and any associated coax wiring.
3. Remove receiver from mounting location. Discard properly per local codes.
4. Reconnect power to operator. Test operator for proper operation.

Trouble-Shooting:

Symptom	Possible Solution
1. Receiver's red STATUS LED does not turn on when programming button pressed.	Check power source to receiver. Insure proper 10 VAC/DC minimum to 28 VAC/DC maximum power source.
2. No transmitter range (less than 10 ft).	Check antenna connections and, if installed, check antenna extension kit coax wire for damage or kinks. Correct antenna connection or replace coax as needed.
3. Poor transmitter range (less than 50 ft).	Insure antenna is not near any metal. Reposition antenna from vertical to horizontal position or vice versa. Possible near-by radio interference.
4. With transmitter activation, the receiver's STATUS LED lights and a "click" is heard within receiver, but receiver does not activate operator.	Check relay (RLY) wire connections. Insure relay wire is not broken or damaged. Insure relay wire is connected to proper terminals on operator. Using insulated pliers or insulated screwdriver, short RLY terminals on receiver and this should activate operator. Test operator for proper operation.
5. Can not learn transmitter.	Insure transmitter is a correct transmitter for this receiver. Check this receiver's RF frequency and the companion transmitter's frequency to insure they are identical. Test receiver with another transmitter.

FCC and IC Statement

FCC Regulatory Information:
This device complies with Part 15 of the FCC Rules. Operation is subject to the following two conditions: (1) this device may not cause harmful interference, and (2) this device must accept any interference received, including interference that may cause undesired operation.

IC Regulatory Information:
Operation is subject to the following two conditions: (1) this device may not cause interference, and (2) this device must accept any interference, including interference that may cause undesired operation of the device.

NOTE: This equipment has been tested and found to comply with limits for a Class B digital device, pursuant to Part 15 of FCC Rules. These limits are designed to provide reasonable protection against harmful interference in a residential installation. This equipment generates, uses and can radiate radio frequency energy and, if not installed and used in accordance with these instructions, may cause harmful interference to radio communication; however, there is no guarantee that interference will not occur in a particular installation. If this equipment does cause harmful interference to radio or television reception, which can be determined by turning equipment off and on, user is encouraged to try to correct interference by one or more of the following measures:
Reorient or relocate receiving antenna. Increase separation between equipment and receiver. Connect equipment into an outlet on a circuit different from that which receiver is connected. Consult your dealer or/and experienced radio/television technician for help.

WARNING: Changes or modifications to this unit not expressly approved by party responsible for compliance could void user's authority to operate this equipment.

RADIO RECEIVER LIMITED WARRANTY

THE MANUFACTURER (WAYNE-DALTON CORP.) WARRANTS ALL COMPONENTS OF THE RADIO RECEIVER MODEL 3990-372, 3994-433 FOR A PERIOD OF 90 DAYS FROM THE TIME OF INSTALLATION AGAINST DEFECTS IN MATERIALS AND WORKMANSHIP, PROVIDED IT IS PROPERLY INSTALLED, USED, MAINTAINED AND SERVICED UNDER NORMAL USE AND SERVICE.

THE ABOVE CONDITIONS APPLY PROVIDED THAT THE ABOVE REFERENCED RADIO RECEIVER MODEL 3990-372, 3994-433 IS PROPERLY INSTALLED, USED, MAINTAINED, AND SERVICED IN ACCORDANCE WITH THE MANUFACTURER'S INSTALLATION AND OPERATING INSTRUCTIONS UNDER NORMAL USE AND SERVICE.

THIS LIMITED WARRANTY EXTENDS ONLY TO THE ORIGINAL PURCHASER, PROVIDED THE ABOVE REFERENCED RADIO RECEIVER IS PROPERLY INSTALLED, USED, MAINTAINED, AND SERVICED. THIS LIMITED WARRANTY IS NOT TRANSFERABLE.

NO EMPLOYEE, DISTRIBUTOR, OR REPRESENTATIVE IS AUTHORIZED TO CHANGE THE FOREGOING WARRANTIES IN ANY WAY OR GRANT ANY OTHER WARRANTY ON BEHALF OF MANUFACTURER.

THE MANUFACTURER SHALL NOT BE RESPONSIBLE FOR ANY DAMAGE RESULTING TO OR CAUSED BY ITS PRODUCTS BY REASON OF INSTALLATION, IMPROPER STORAGE, UNAUTHORIZED SERVICE, ALTERATION OF PRODUCTS, NEGLIGENCE OR ABUSE, ANY ACTS OF NATURE BEYOND MANUFACTURER'S CONTROL (SUCH AS, BUT NOT LIMITED TO, LIGHTNING, POWER SURGES, WATER DAMAGE, ETC.), OR ATTEMPT TO USE THE PRODUCTS FOR OTHER THAN THE CUSTOMARY USAGE OR FOR THEIR INTENDED PURPOSES. THE ABOVE WARRANTY DOES NOT COVER NORMAL WEAR OR ANY DAMAGE BEYOND MANUFACTURER'S CONTROL OR REPLACEMENT LABOR.

CLAIMS FOR DEFECTS IN MATERIAL AND WORKMANSHIP COVERED BY THIS WARRANTY SHALL BE MADE IN WRITING, WITHIN THE WARRANTY PERIOD, TO THE DEALER TO WHOM THE PRODUCT WAS PURCHASED. MANUFACTURER MAY EITHER SEND A SERVICE REPRESENTATIVE OR HAVE THE PRODUCT RETURNED TO THE MANUFACTURER AT BUYER'S EXPENSE FOR INSPECTION. IF JUDGED BY MANUFACTURER TO BE DEFECTIVE IN MATERIAL OR WORKMANSHIP, THE PRODUCT WILL BE REPLACED OR REPAIRED AT THE OPTION OF THE MANUFACTURER, FREE FROM ALL CHARGES EXCEPT AUTHORIZED TRANSPORTATION AND REPLACEMENT LABOR.

THE REMEDIES OF BUYER SET FORTH HEREIN ARE EXCLUSIVE AND ARE IN LIEU OF ALL OTHER REMEDIES. THE LIABILITY OF MANUFACTURER, WHETHER IN CONTACT, TORT, UNDER ANY WARRANTY OR OTHERWISE, SHALL NOT EXTEND BEYOND ITS OBLIGATION TO REPAIR OR REPLACE, AT ITS OPTION, ANY PRODUCT OR PART FOUND BY MANUFACTURER TO BE DEFECTIVE IN MATERIAL OR WORK. MANUFACTURER SHALL NOT BE RESPONSIBLE FOR ANY DIRECT, INDIRECT, SPECIAL OR CONSEQUENTIAL DAMAGES OF ANY NATURE.

THIS WARRANTY GIVES YOU SPECIFIC LEGAL RIGHTS, AND YOU MAY HAVE OTHER RIGHTS, WHICH MAY VARY FROM STATE TO STATE. HOWEVER, SOME STATES DO NOT ALLOW LIMITATION ON HOW LONG AN IMPLIED WARRANTY LASTS OR THE EXCLUSION OR LIMITATION OF INCIDENTAL OR CONSEQUENTIAL DAMAGES SO THE ABOVE LIMITATIONS OR EXCLUSIONS MAY NOT APPLY TO YOU.



**Questions?
Need Information?**

**Call Us Toll-Free:
(888) 827-3667**

**Thank you for your purchase
www.waynedalton.com**

Please Do Not Return This Product To The Store

Call Us Directly! Our Trained Technicians Will Answer Your Questions and /or Ship Any Parts You May Need.